

## Installation :

Project number : Gainety Szkoła Jurków

Customer :

Processed by :

Date : 04.12.2025

The following values are based on precise calculations performed on calibrated lamps and luminaires, and their configurations, whereby gradual, unavoidable deviations can occur in practice. All guarantee claims are excluded for the specified data.

This exclusion of liability applies irrespective of the legal grounds for both damages and consequential damages suffered by users and third parties.



1 01 pok. terapeutyczny

1.1 Summary, 01 pok. terapeutyczny

1.1.1 Result overview, Evaluation area 1

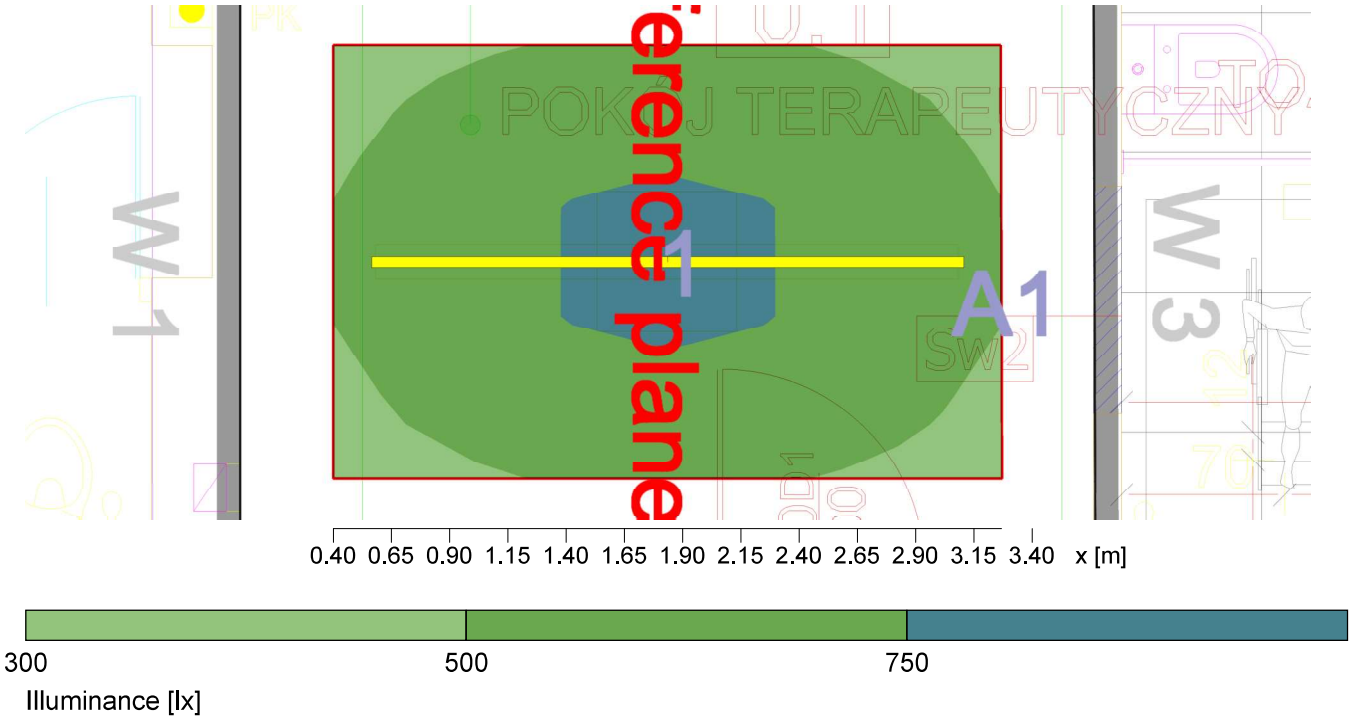

General

Calculation algorithm used	Average indirect fraction
Height of luminaire plane	3.00 m
Maintenance factor	0.80
Total lamp luminous flux	8933.00 lm
Luminaire luminous flux	8932.48 lm
Total power	79.0 W
Total power per area (9.75 m²)	8.11 W/m² (1.28 W/m²/100lx)

Evaluation area 1

Reference plane 1.1

	Horizontal	cylindrical
$\bar{E}_m$	632 lx	191 lx
$E_{min}$	474 lx	177 lx
$E_{min}/\bar{E}_m (U_o)$	0.75	0.93
$E_{min}/E_{max} (U_d)$	0.60	
$E_z/E_h$		0.26
Position	0.85 m	1.20 m

Type No.Make

5	1 x	TRILUX	
		Order No.	:
		Luminaire name	: LC44 G6 UGR NT P9 H 840 ET 01 IP40
		Equipment	: 1 x LED 79 W / 8933 lm
A1			



**TRILUX**  
SIMPLIFY YOUR LIGHT.



**TRILUX**  
SIMPLIFY YOUR LIGHT.



3 03 korytarz

3.1 Summary, 03 korytarz

3.1.1 Result overview, Evaluation area 1

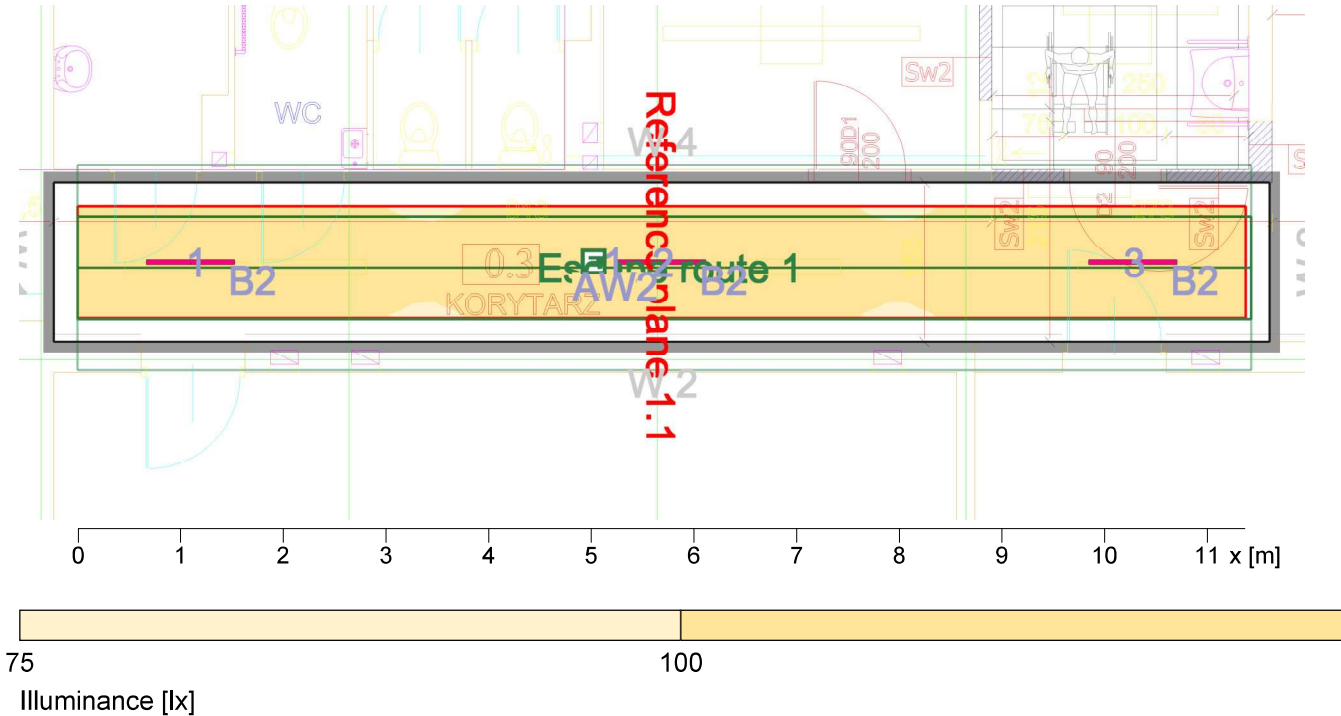

General

Calculation algorithm used	Average indirect fraction
Height of luminaire plane	3.00 m
Maintenance factor	0.80
Total lamp luminous flux	8115.00 lm
Luminaire luminous flux	8114.70 lm
Total power	78.0 W
Total power per area (18.34 m²)	4.25 W/m² (3.40 W/m²/100lx)

Evaluation area 1	Reference plane 1.1	
	Horizontal	cylindrical
$\bar{E}_m$	125 lx	46 lx
$E_{min}$	99 lx	40 lx
$E_{min}/\bar{E}_m (U_o)$	0.79	0.89
$E_{min}/E_{max} (U_d)$	0.67	
$E_z/E_h$		0.32
Position	0.00 m	0.35 m

Type No. Make

1	3 x	TRILUX	
		Order No.	:
		Luminaire name	: LC44 G6 OTA NT P3 H 840 ET 01 IP40
		Equipment	: 1 x LED 26 W / 2705 lm
B2			

303 korytarz

3.2 Summary, 03 korytarz

3.2.1.1 Result overview (emergency lighting)

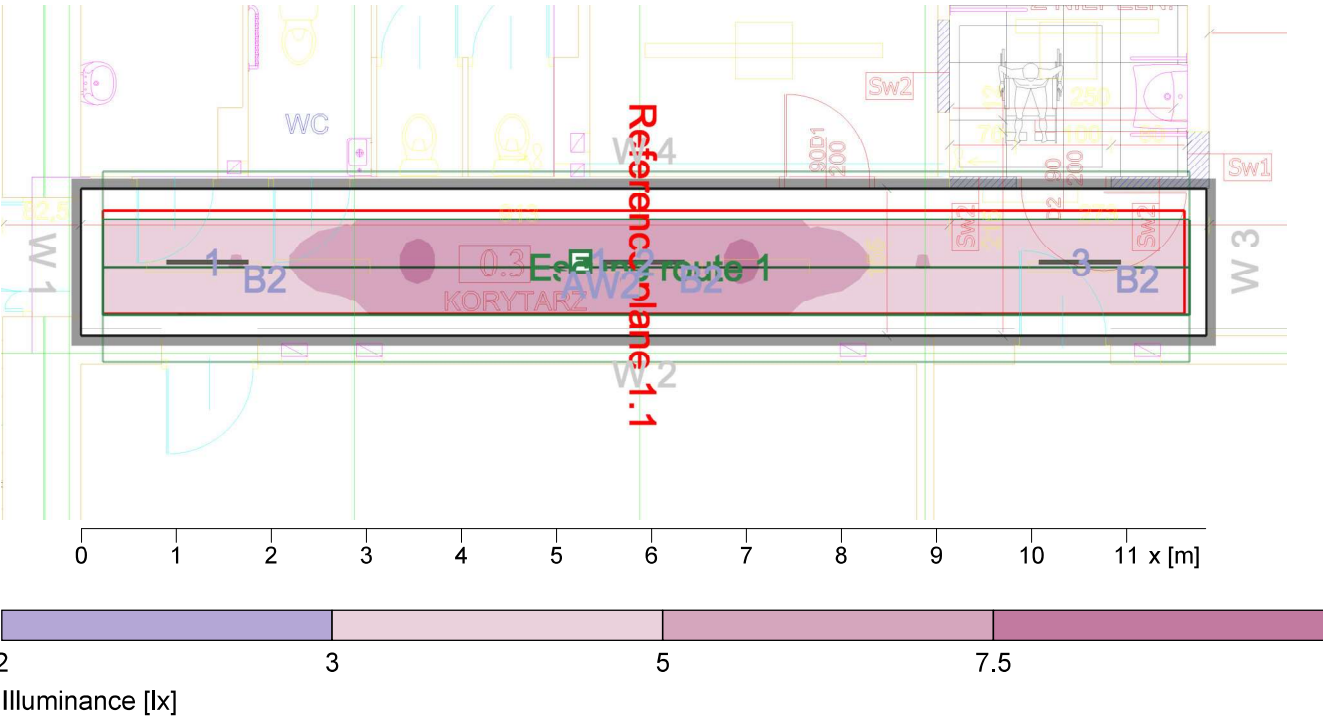

General

Calculation algorithm used

Maintenance factor

Height (phot. centre)

Maximum I

: Direct component

: 0.8

: 2.97 m

: 780 cd

<= 900 cd

Escape routes:

No.	Central axis		Ud	Surface	
	Emin [lx]	Emax [lx]		Emin [lx]	Emax [lx]
<b>Escape route 1</b>					
Calculation field: 11.42m x 1m (57 x 9 pts), Height = 0.00m					
1	3.92 lx	8.03 lx	1: 2.05	2.79 lx	8.03 lx
	>= 1 lx		>= 1 : 40	>= 0.5 lx	

Type No. \ Make

2

1E x

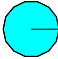

AW2

TRILUX - TM TECHNOLOGIE

Order No.

Luminaire name

Equipment

Emergency

: 234\_NM

: TM-IT.C1.60 NM

: 1 x Integral module 1xLED 1.2 W / 369 lm (0%)

: 369 lm

-- Emergency Lighting --



**TRILUX**  
SIMPLIFY YOUR LIGHT.

4 04 hall

4.2 Summary, 04 hall

4.2.1.1 Result overview (emergency lighting)

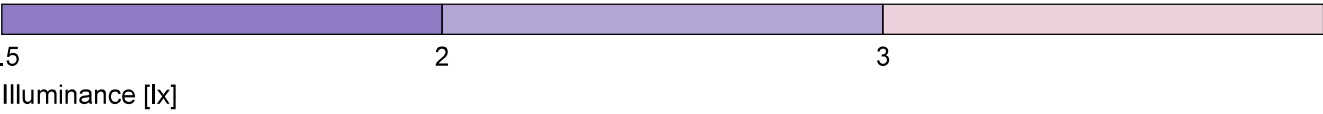
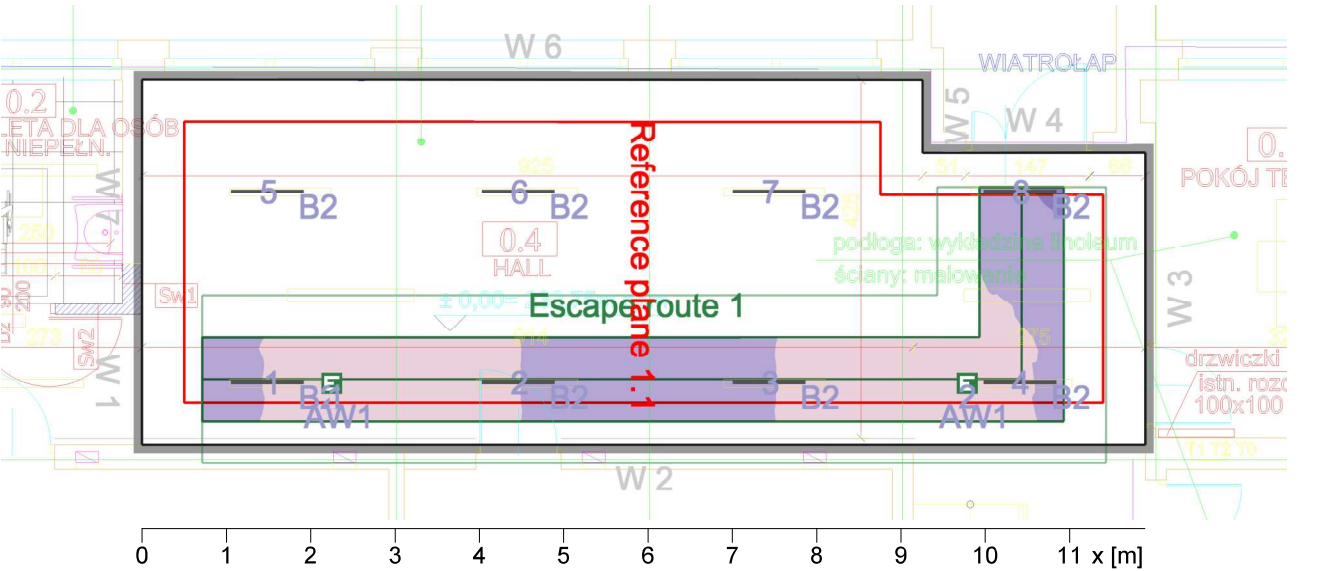

General

Calculation algorithm used : Direct component  
Maintenance factor : 0.8  
Height (phot. centre) : 2.97 m  
Maximum I : 270 cd <= 900 cd

Escape routes:

No.	Central axis		Ud	Surface	
	Emin [lx]	Emax [lx]		Emin [lx]	Emax [lx]
<b>Escape route 1</b>					
Calculation field: 11.99m x 1m (60 x 9 pts), Height = 0.00m					
1	2.09 lx	3.55 lx	1: 1.70	1.76 lx	3.61 lx
	>= 1 lx		>= 1 : 40	>= 0.5 lx	

Type No. Make

3 2E x  **TRILUX - TM TECHNOLOGIE**  
Order No. : 240\_NM -- Emergency Lighting --  
Luminaire name : TM-IT.S1.60 NM  
Equipment : 1 x Integral module 1xLED 1.2 W / 377 lm (0%)  
Emergency : 377 lm  
AW1





5 05 pokój terapeutyczny

5.1 Summary, 05 pokój terapeutyczny

5.1.1 Result overview, Evaluation area 1

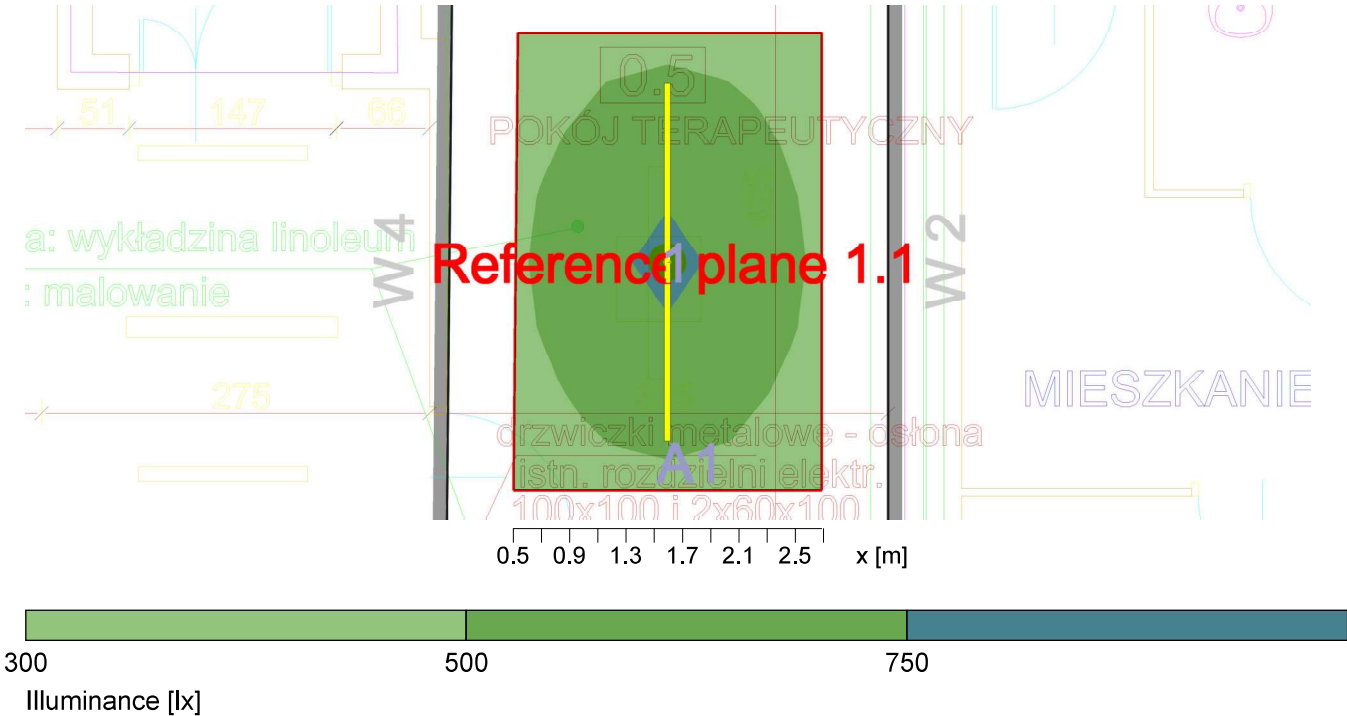

General

Calculation algorithm used	Average indirect fraction
Height of luminaire plane	3.00 m
Maintenance factor	0.80
Total lamp luminous flux	8933.00 lm
Luminaire luminous flux	8932.48 lm
Total power	79.0 W
Total power per area (13.03 m²)	6.06 W/m² (1.09 W/m²/100lx)

Evaluation area 1	Reference plane 1.1	
	Horizontal	cylindrical
$\bar{E}_m$	555 lx	163 lx
$E_{min}$	353 lx	140 lx
$E_{min}/\bar{E}_m (U_o)$	0.64	0.86
$E_{min}/E_{max} (U_d)$	0.45	
$E_z/E_h$		0.25
Position	0.85 m	1.20 m

Type No.Make

5	1 x	TRILUX	
		Order No.	:
		Luminaire name	: LC44 G6 UGR NT P9 H 840 ET 01 IP40
		Equipment	: 1 x LED 79 W / 8933 lm
A1			

6 06 pokój terapeutyczny

6.1 Summary, 06 pokój terapeutyczny

6.1.1 Result overview, Evaluation area 1

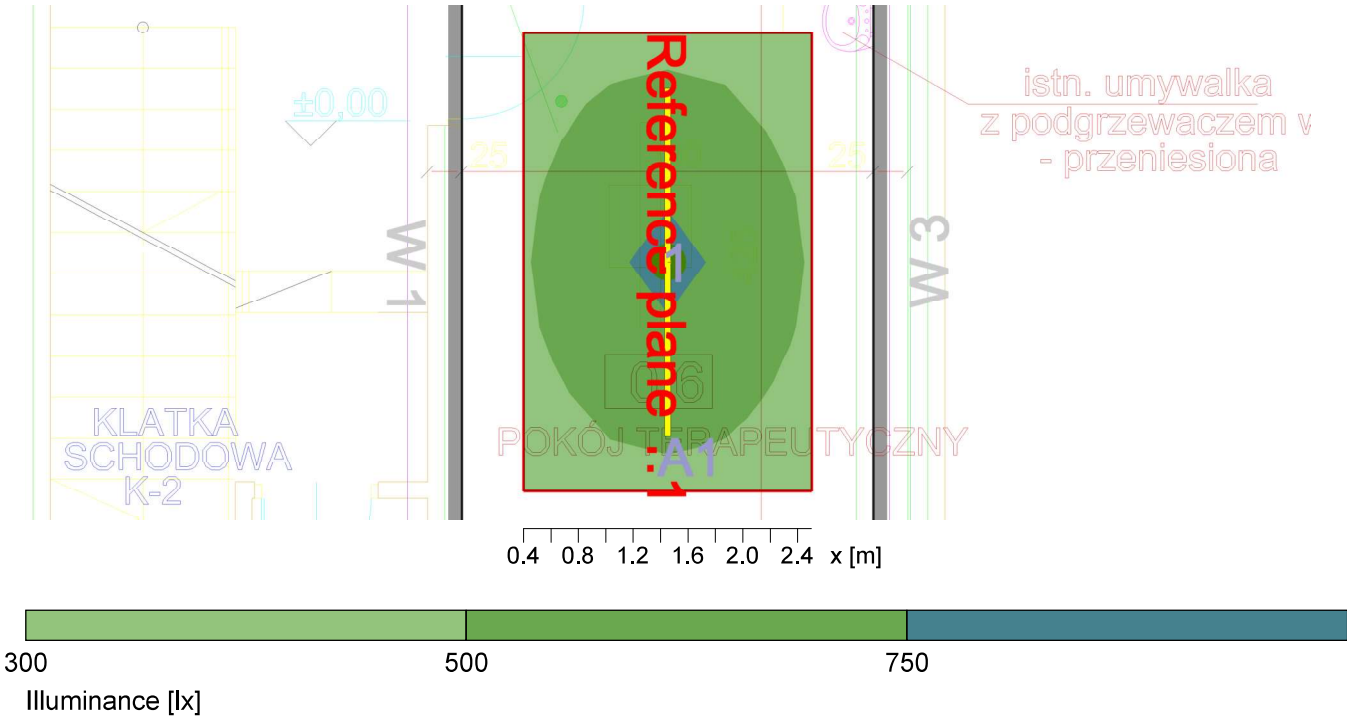

General

Calculation algorithm used	Average indirect fraction
Height of luminaire plane	3.00 m
Maintenance factor	0.80
Total lamp luminous flux	8933.00 lm
Luminaire luminous flux	8932.48 lm
Total power	79.0 W
Total power per area (12.75 m²)	6.20 W/m² (1.11 W/m²/100lx)

Evaluation area 1

Reference plane 1.1

	Horizontal	cylindrical
$\bar{E}_m$	559 lx	166 lx
$E_{min}$	358 lx	143 lx
$E_{min}/\bar{E}_m (U_0)$	0.64	0.86
$E_{min}/E_{max} (U_d)$	0.46	
$E_z/E_h$		0.25
Position	0.85 m	1.20 m

Type No. Make

5	1 x	<b>TRILUX</b>	
		Order No.	:
		Luminaire name	: LC44 G6 UGR NT P9 H 840 ET 01 IP40
		Equipment	: 1 x LED 79 W / 8933 lm
A1			